



Addendum #2

IFB # 21-005

GOLDMINE PARK

*****FINAL*****

April 21, 2021

Questions and Clarifications

2.1 Screening plant material – ADD to bid form as unit price section.

A: Add (20) 2-inch caliper Tree-Acer Rubrum to unit priced scope reflected in item G of bid proposal form (new attachment).

Add (30) 5-gal Shrub Ilex (Attenuata 'Eagleston' or approved equal) to unit priced scope reflected in item G of bid proposal form (new attachment).

Add (20) 3-gal Shrub-Abelia to unit priced scope reflected in item G of bid proposal form (new attachment).

2.2 See documentation below from HGB on questions from pre-bid meeting.

1.10 It doesn't appear that there are drainage structures proposed for the decel lane or driveway. Is this correct or will there be another addendum addressing this?

Sheet - NA

HGB Response - Based on the existing survey, the proposed driveway and deceleration lane are located near a high point in Level Creek Road. As a result, the offsite drainage coming onto the site is anticipated to be minimal. Drainage from Level Creek Road is proposed to flow onto the site as sheet flow, be directed to Yard inlet 1-E, and then conveyed to the Detention pond for treatment. Additional temporary velocity mitigation for concentrated flow (Erosion Control Blanket) should be sufficient during construction, until permanent vegetative stabilization has been established. No additional storm water conveyances appear to be required at this time.

1.18 There are currently no BMP's shown in the right of way of Level Creek. Can you provide clarification if additional BMP's will be required?

Sheet - 9, Erosion & Sediment Control Plan - intermediate Phase

HGB Response - Provide additional type-S silt fencing (+/- 300 lf) and Erosion Control Blanket (+/- 350 SY) as depicted on the attached sketch. Silt fence shall be per detail Sd1-S sheet 12, Erosion Control Blanket shall be "Curlex II" with biodegradable FibreNet on both sides, BioD-StrawCoco with 30% coconut fiber matrix and natural biodegradable netting on both sides, "Tensar, North American Green BioNet SC150BN" erosion control blanket with biodegradable thread and 30% coconut fiber matrix, or Other approved equal.

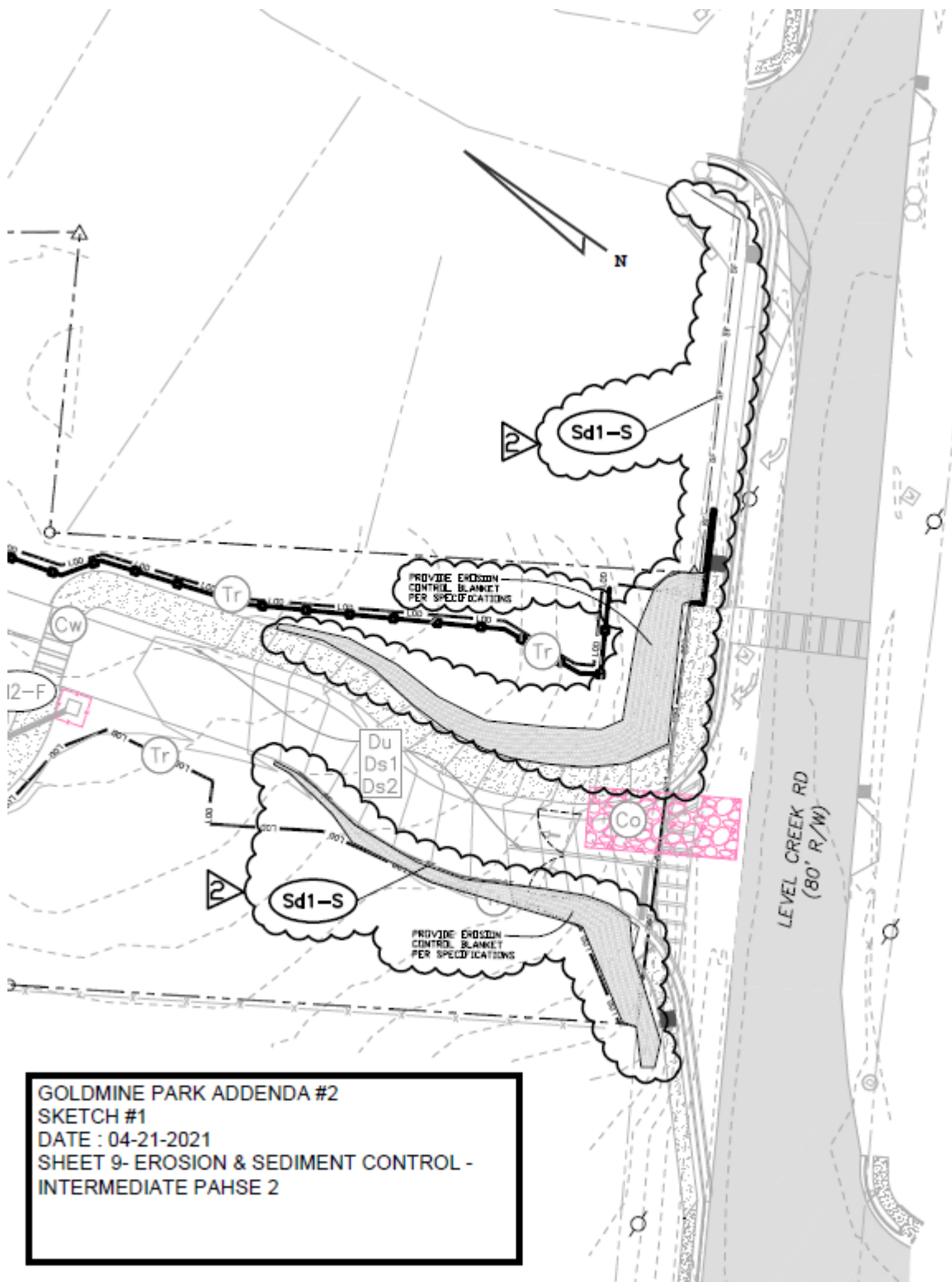

***See attached bid proposal form*

END OF ADDENDUM #2 – 21-005

SECTION 004113 – FORM OF PROPOSAL

TO: Mr. Troy Besseche, Owners Representative
City of Sugar Hill

I have received and reviewed bid documents, dated and titled:

**GOLD MINE PARK SITE WORK CONSTRUCTION AND REST ROOM FACILITY,
CITY OF SUGAR HILL**

I have also received Addenda No. _____ and have included their provisions in my bid. I have examined both the documents and the site and submit the following bid.

In submitting this bid, I agree:

- A. To accomplish the work in accordance with the Contract Documents.
- B. To construct, by the deadlines indicated in heading E below, Goldmine Park for a sum of:

ITEM NO. 1: Base Proposal (Not including Allowances)

_____ DOLLARS (\$ _____)

ITEM NO. 2: Allowances (sum total of items listed in heading F below)

_____ DOLLARS (\$ _____)

TOTAL BASE BID* (TOTAL OF ITEM NO. 1 & 2 ABOVE)

_____ DOLLARS (\$ _____)

-* Hereinafter referred to as the **Base Bid**.

- C. To execute a Contract, if awarded, on the basis of this bid and to furnish Performance and Payment Bonds.

D. To hold my bid open until 60 days after bid date.

E. To be substantially complete by **July 20, 2021**.

Failure to meet this deadline is grounds to be excluded from future bids by City of Sugar Hill.

F. **ALLOWANCES:** To provide as a part of the Base Bid an allowance for sum total of all work related to the below outlined.

Unsuitable materials shall be defined as:

1. Substances not capable of being compacted to the density specified,
2. Rock material larger than ½ cubic foot in volume,
3. Debris and organic material. Such materials shall be determined by the Owner's Geotechnical Testing Agency;
4. Materials which are not suitable for use on this project;
5. Unsuitability for sale of materials to third parties is not included in this definition.

Soil material which is too wet to permit the specified compaction but is still suitable to be used in structural capacity (once dried) based on the recommendations of the soils testing agency, shall be spread and permitted to dry in an area to be designated by the Architect. Contractor shall assist drying by discing, harrowing or pulverizing until the soil moisture content is reduced to the specified value. Only excavation of soil which is wet due to a concealed condition, including, but not limited to, underground springs, high water table and leaking pipes, shall be addressed as a potential additive change order. Suitable materials which are wet due to precipitation as determined by the Owner's Testing Agency shall be dried as specified and reused at no additional cost.

Allowances in Base Bid:

1. Fill and compact with suitable soils acquired on-site to replace unsuitable soils removal 50 cubic yards @ \$ _____ /cy
2. Fill and compact with suitable soils acquired off-site to replace unsuitable soils removed 50 cubic yards @ \$ _____ /cy
3. Excavate materials determined to be unsuitable by the Owner's Testing Agency and redistribute on the site 50 cubic yards @ \$ _____ /cy
4. Trench rock excavation, distribution and approved burial 50 cubic yards @ \$ _____ /cy
5. Trench rock excavation and removal from site 50 cubic yards @ \$ _____ /cy

6. Mass rock removal, excavation, distribution and approved burial 100 cubic yards @ \$ _____ /cy
7. Mass rock removal, excavation and removal from site 100 cubic yards @ \$ _____ /cy
8. Furnish and install 130,680 s.f. of (2.4 acres) of APS 600 series silt stop as manufactured by Applied Polymer Systems, Norcross, Georgia or approved equal at a rate of 1.5 gallons per acre in a hydroseeder mix of appropriate seed, fertilizer, lime and mulch for the same acre. Follow all manufacturer's instruction and recommendations. Do not mechanically disturb treated areas after application.....2.4 acres @ \$ _____ /acre
9. Contractor shall furnish, install and maintain APS 700 series silt stop as manufactured by Applied Polymer Systems, Norcross, Georgia or approved equal 100 lbs @ \$ _____ /lb
10. Contractor shall furnish, install and maintain Erosion and Sediment Control Silt Fence (Sd1) 1300 l.f. @ \$ _____ /lf
11. Contractor shall furnish, install and maintain Erosion and Sediment Control Inlet Sediment Trap (Sd2-F)..... 4 @ \$ _____ /ea
12. Contractor shall furnish, install and maintain Erosion and Sediment Control Matting Blanket (Ss)..... 2100 sq.yards @ \$ _____ /sy
13. Plaque: Contractor shall furnish and install plaque per specifications section 101416. See Allowances section 012100 1 @ \$ _____ /ea

G UNIT PRICES (not in Base Bid): To adjust the Contract amount based on the requirements of Section 012200: UNIT PRICES, if necessary, by the following amounts

The undersigned bidder agrees to provide additional work, if added, or to delete specified work, if requested, at the unit prices listed unless such prices have been equitably adjusted by the Engineer as previously stated. The unit prices include charges for fee, layout, supervision (field, and home office), general expense, taxes, insurance, labor burden overhead and profit.

1. Furnish and install a woven geotextile fabric suitable for heavy duty traffic over earth subgrade in conjunction with #57 stone stabilization\$ _____ /sy

2. Furnish and install stone stabilization base materials including:
 - a. Graded Aggregate Base \$ _____ /ton
 - b. Gravel (#57 Stone) \$ _____ /ton
 - c. Crusher Stone (#810)..... \$ _____ /ton
 - d. Granular Bedding \$ _____ /ton
 - e. 50 lb. rip rap \$ _____ /ton
 - f. 100 lb. rip rap – grouted \$ _____ /ton

3. Furnish and install storm/sanitary sewer cleanout outside of pavement..... \$ _____ /vf
4. Furnish and install storm/sanitary sewer cleanout within paved area..... \$ _____ /vf

6. Furnish and install pipe materials including:
 - a. 6"Ø Schedule 40 PVC
 - 4' deep to 8' deep \$ _____ /lf
 - b. 18"Ø Aluminized Type 2 Storm pipe
 - 4' deep to 8' deep \$ _____ /lf

- * Cost shall include all appurtenances, including fittings, bands, wyes, etc. and all appurtenant details.

- * All AST-2 shall be aluminized as per Section 334000. Cost shall include all appurtenant including fittings, bands, wyes, etc. and all appurtenant details.

7. Furnish and install:
 - a. Precast 48" diameter concrete storm drainage structures \$ _____ /vf
 - b. 48" diameter brick storm drainage structures \$ _____ /vf
 - c. Heavy duty cast iron grate and frame..... \$ _____ /set
 - d. Cast iron ring and cover as per City of Sugar Hill Standards \$ _____ /set

8. Furnish and install Sensitive- Type S Erosion Control Silt Fence..... \$ _____ /lf

9. Furnish and install 2-inch caliper Tree-Acer Rubrum..... \$ _____ /ea

10. Furnish and install 5-gal Shrub-Ilex (Attenuata)..... \$ _____ /ea

11. Furnish and install 3-gal Shrub-Abelia..... \$ _____ /ea

Above listed unit prices are amounts to be used for work that will be **added to or deleted from** the Contract by Change Order in the event such additional work may be required. The Owner reserves the right to accept or reject these unit prices or require the work to be Performed on a time-and-materials basis with complete daily breakdown and logs submitted.

H. To accept all provisions of the Instructions to Bidders.

I. List of Subcontractors

MECHANICAL/HVAC _____

PLUMBING _____

ELECTRICAL _____

THE UNDERSIGNED HAS CHECKED CAREFULLY ALL FIGURES ABOVE AND UNDERSTANDS THAT THE OWNER WILL NOT BE RESPONSIBLE FOR ANY ERRORS OR OMISSIONS ON THE UNDERSIGNED IN MAKING THIS BID.

BY:

(PRINT NAME AND SIGN)

TITLE: _____

COMPANY: _____

ADDRESS: _____

WITNESS: _____

COMPANY SEAL:

The Attorney-in-fact must file with Bid Bond a certified copy of his Power-of-Attorney to sign bond.

County of _____, State of _____, personally before me, the undersigned authority, appeared _____, who is known to me to be an official of the firm of _____. Who, after being duly sworn, stated on hid oath that he had read the above and that the same is true and correct.

Notary Public

My Commission Expires

Contractor to provide Bid Bond and Performance Bond on the forms referenced below. AIA forms may be obtained from a local blue print company; City of Sugar Hill forms may be obtained from the Owner through the Architect.

The following documents may also be obtained from the Architect by written request:

- Bid Bond, AIA Document A310, Latest Edition
- City of Sugar Hill "Performance Bond" and "Payment Bond"
- City of Sugar Hill "Standard Form of Agreement Between Owner and Contractor"
- City of Sugar Hill "General Conditions"

END OF SECTION 004113