

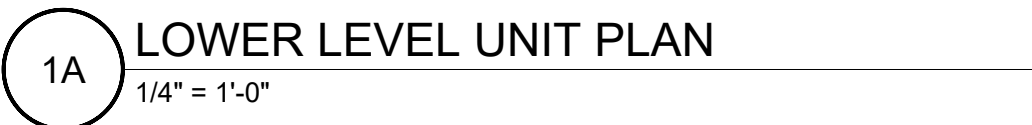

E+E ARCHITECTURE INC. IS NOT RESPONSIBLE FOR INTERPRETING THE INTENT OF THE CONSTRUCTION DOCUMENTS, INCLUDING MAKING MODIFICATIONS AS MAY BE NECESSARY DURING THE CONSTRUCTION PHASE; AND THAT E+E ARCHITECTURE INC. IS NO LONGER LIABLE FOR THE WORK WHERE CHANGES TO THESE DOCUMENTS HAVE BEEN MADE.



Seal

No.	Date	Issue Notes



297 PRINCE AVE. SUITE 28B  
ATHENS, GEORGIA  
O: 706.850.1330

## REVISED FLOOR PLAN OPTIONS

Date	9.1.21	Project Number  2020-62
CAD File Name		

# A-1.0